

IMPORTANT:

Precautions must be taken to eliminate passenger or maintenance personnel exposure to UV-C light, mount the module accordingly. Warning stickers provided must be placed where visible to warn maintenance personnel of the potential for UV-C exposure.

- Module must be installed with 12VDC 500mA fused protection.
- To be installed to operate only while handrail is moving. Prolonged UV-C light exposure to idle handrail will cause damage.
- Installation and maintenance of this device must be completed by trained individuals with knowledge of the operational hazards and risks of escalators and moving walks.

1. Turn **OFF** escalator.

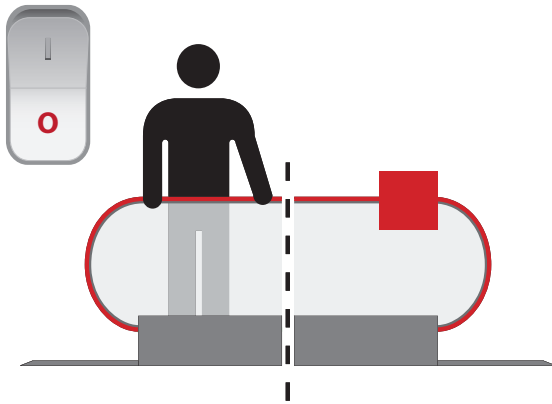

2. Select location for mounting module where handrail will not deviate from path (>2mm).

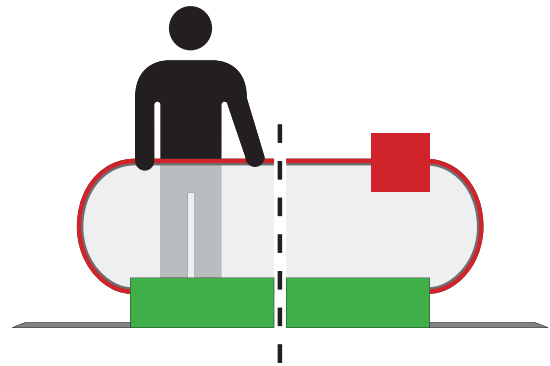

3. Reflector surface must be centered 5-10mm from handrail surface.

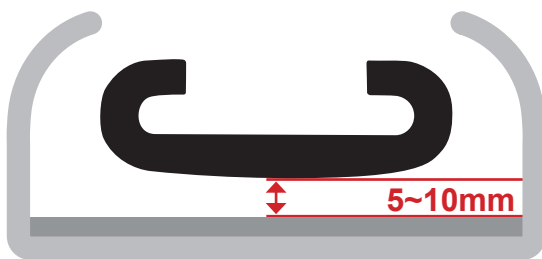

4. Mount circuit board within protective enclosure, supply with 12VDC 500mA, place safety label next to the module and return escalator to service.

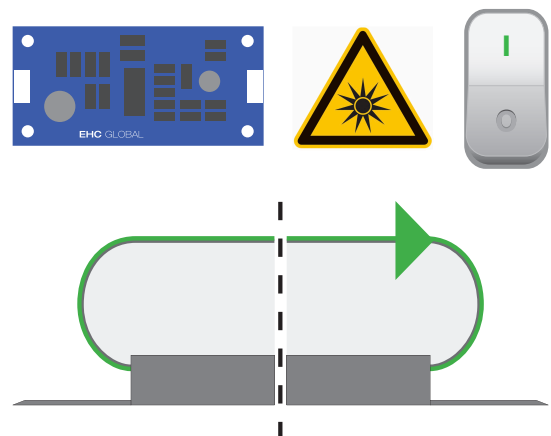

Avoid contact between handrail and module.



All EHC Global products are backed by an industry leading warranty. For more warranty information, scan the QR code on the left or visit: <http://www.ehc-global.com/warranty>

Personal Protective Equipment (PPE) should be worn at all times.

